

MANUAL SPRAY PAINTING LINE

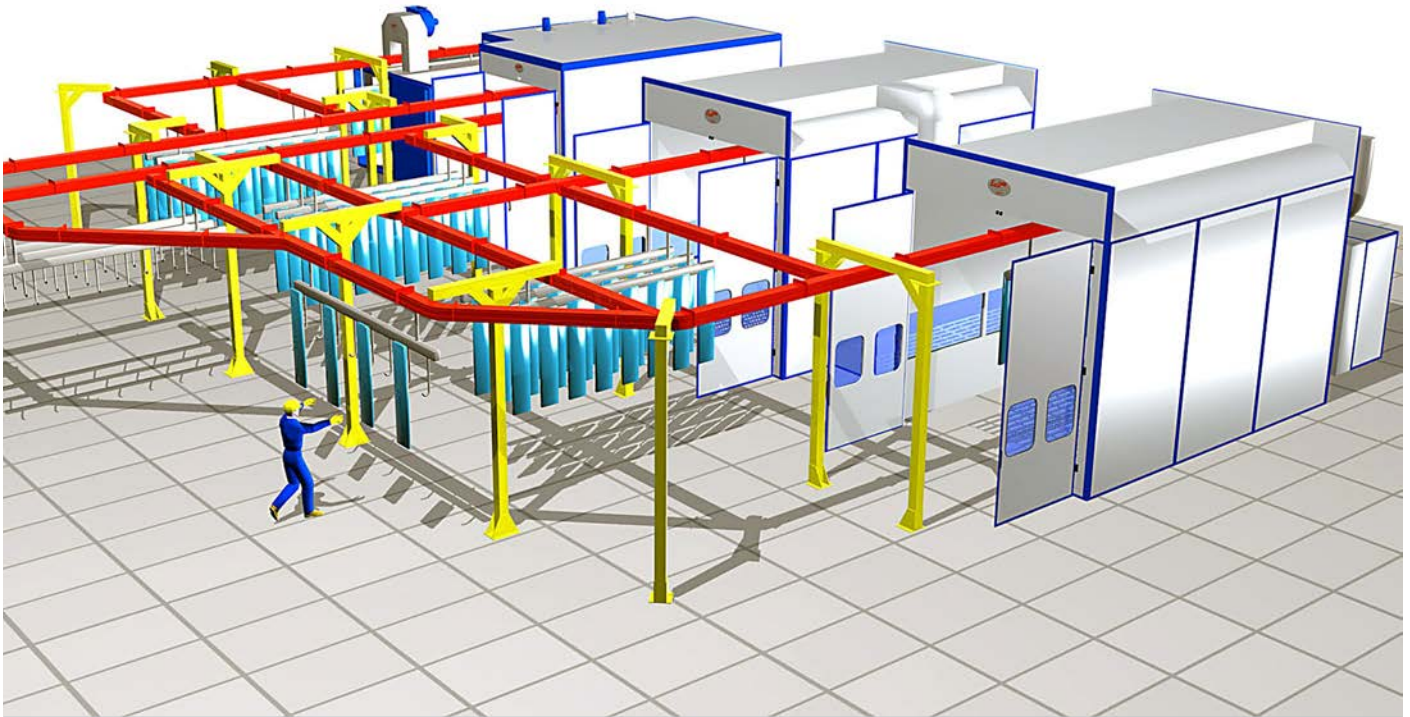

**Flexible spray painting line, suitable for painting of small lots
with different dimensions and various colors**



Washing cell



Manual washing



Overhead conveyor



Spray painting



Curing oven

OPTIONAL ACCESSORIES

Different loads of overhead conveyor
Change of washing phases
Painting booth with water veil filter wall and/or pressurized
Electric and mechanical assembly
Diesel oil burner

NOTES

Spray line with overhead conveyor includes:

- Manual overhead conveyor
- Multiphase wash cell
- Manual washing booth for big parts
- Painting booth with dry filter
- Drying and curing oven of painted parts

Materials: overhead, conveyor, washing and painting booth made from galvanized steel sheet, washing cell from stainless steel sheet, frame made from painted steel profiles

Isolation of oven: mineral wool, thickness 80 mm, density 100 kg/m³, temperature 100°C

Methane or LPG burners

Shipment: part kit

Dimensions and technical data are approximate and can be adapted to specific customer's requirements

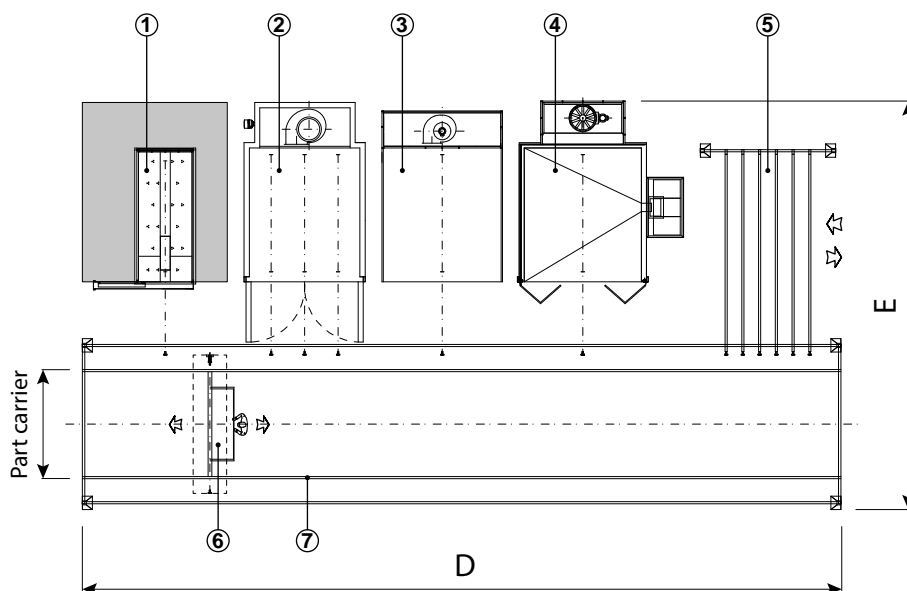

USEFUL DIMENSIONS OF PARTS

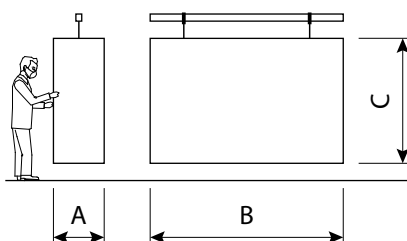

- ① AUTOMATIC WASHING CELL
- ② DRYING AND CURING OVEN
- ③ SPRAY PAINTING BOOTH
- ④ MANUAL WASHING BOOT
- ⑤ STORAGE AREA
- ⑥ MANUAL CONVEYOR
- ⑦ OVERHEAD RAILS

DESCRIPTION OF EQUIPMENT

Model	Useful dimensions						Outside dimensions			
	With automatic washing cell			With manual washing boot			D	E	H max	Part carrier
A	B	C	A	B	C					
Euro MAN L	800	3.000	2.000	1.800	3.000	2.000	25.000	15.000	4.200	3.000

TECHNICAL CHARACTERISTICS

Model	Overhead conveyor	Load of overhead conveyor	Total electric power	Total heat power	Burner	Air and fumes extraction chimneys
	nb	Kg/m	kW	kCal/h	nb	nb
Euro MAN L	1	145	0	0	2	5